

GF11 Die Cast Lift-Off Hinge (For Flush Doors)

Features

- Simple way to hang flush doors on metal cabinets, electrical enclosures, etc. allowing "lift-off" capability from a narrow door surrounding
- 'Handed', left- and right -, these hinges provide great flexibility in a variety of configurations. See schemes below. Use one hinge of each hand to create a non-lift-off, permanently retained door.
- Bottom half of hinge contains a fixed, stainless steel pin, and is fitted to door frame. Top half is fitted to face of door and is lifted on (and off) pin. Movement is completely free.
- Plant-on fitting, with two holes in base of each portion, tapped for M6 bolts

Material

- Body: Zinc die cast, chromium plated / black powder coated / raw finish
- Pin: Stainless steel



GF11-G01967
(left-hand)

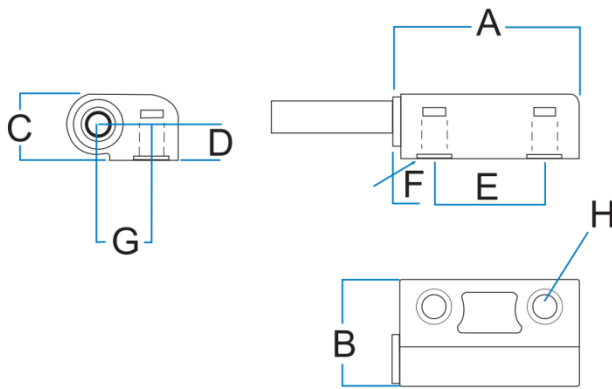

Door Fixing Modes

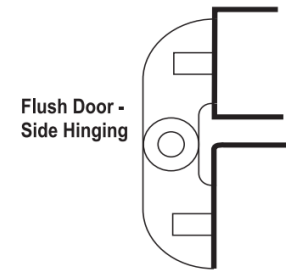
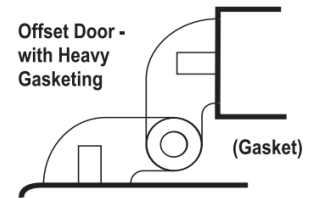
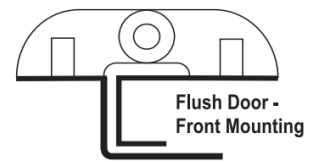

Part No.	Type	Finish	A	B	C	D	E	F	G	H	Pin Diameter
GF11-G01966	Right-hand	Chrome	43	25.5	15	8.5	25.5	9.5	12.7	M6 x 9	6
GF11-G01967	Left-hand										
GF11-G01966B	Right-hand	Black									
GF11-G01967B	Left-hand										
GF11-G01966R	Right-hand	Raw									
GF11-G01967R	Left-hand										